

HAYMAN REESE
PART No: 03105RLW
SKODA OCTAVIA NE WAGON 11-13 ON
INSTALLATION INSTRUCTIONS

PLEASE ENSURE THAT ALL INSTRUCTIONS ARE UNDERSTOOD PRIOR TO FITMENT
PLACE THESE INSTRUCTIONS IN THE VEHICLE'S GLOVEBOX AFTER INSTALLATION IS COMPLETED



Installation Time: Approx **60** Mins

Towbar Installation Instructions

Towbar capacity

SKODA OCTAVIA NE WAGON 11-13 ON

Part Number 03105RLW

Max Towing Braked 1600 kg

Max Towing Unbraked 740 kg

Max Static Ball Load 75 kg

Hayman Reese (Cequent)
PO Box 4050, Dandenong South VIC 3164
Phone 1800 812 017 Email info@haymanreese.com.au

HAYMAN REESE

PART No: 03105RLW

SKODA OCTAVIA NE WAGON 11-13 ON

INSTALLATION INSTRUCTIONS

PLEASE ENSURE THAT ALL INSTRUCTIONS ARE UNDERSTOOD PRIOR TO FITMENT
PLACE THESE INSTRUCTIONS IN THE VEHICLES'S GLOVEBOX AFTER INSTALLATION IS COMPLETED

Warning:

1. Do not, drill, cut, weld or otherwise modify the towbar.
2. If you are using electric welding on a motor vehicle, **always** check that the vehicle is not equipped with electronic engine or instrument management equipment. Failure to do so could **destroy** any onboard computers. If in doubt, check with the vehicle's manufacturer.

General:

1. Ensure all hardware items have been included, refer to assembly diagram.
2. It is recommended that the instructions are read through and completely understood before making any attempt to fit this product.
3. Be wary of any changes to vehicle designs or other accessories that may conflict with the installation of this product.
4. Before drilling, ensure that the area is clear of fuel, electrical & other components.
5. All holes drilled into the body panels shall have all burrs & swarf removed then coated with a suitable rust preventative paint.
6. The high tensile fasteners supplied with this product were used to achieve the specified rating. If replacement is required ensure that fasteners of the same rating & quality are used. Contact an authorised **Hayman Reese** dealer if further information is required.
7. Ensure that all hardware is fastened to torque list below, check fasteners on regular basis.
8. Towbar load rating sticker provided with this product shall be conspicuously located on inside rear end of the driver's door. **(See diagram below)**.
9. Hayman Reese recommends that you check your tow ball to ensure that it complies with the Australian Standards **AS 4177.2**.
10. **PLEASE NOTE:** It is advised to remove your lug or TBM when not actually towing so as to produce a clear view of the vehicles registration plate if obscured, and to also provide maximum available departure angle.
11. Pull Pin must be fit in down position.

Tow bar Maintenance and Care.

Hayman Reese recommends that bolt torques, as listed below, are routinely and regularly inspected and checked for correct tension. Replace any worn or defective parts.

We recommend to remove Tow Ball Mounts (TBM's, tongues or lugs) when not being used for any considerable length of time.

So as to avoid injury, when not towing it is suggested that the tongue, Pull Pin and R-clip are removed then stored in a safe, clean and dry place, away from excessive moisture.

Hitch Pull Pins and spring "R" clips are to be regularly checked for proper installation. Replace any worn or defective parts.

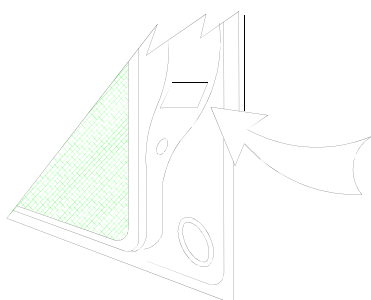

Place load rating sticker
inside driver's door here

RECOMMENDED ASSEMBLY TORQUE LISTING

Diameter Grade 8.8 Bolt

M6	9.0 Nm
M8	22.1 Nm
M10	44.2 Nm
M12	77.3 Nm
M14	124.1 Nm
M16	196.5 Nm

FOR TOWING PURPOSES ONLY

For towing capacity details please refer to vehicle owner's manual or to the manufacturer. Overloading can void your warranties.

HAYMAN REESE
PART No: 03105RLW
SKODA OCTAVIA NE WAGON 11-13 ON
INSTALLATION INSTRUCTIONS

PLEASE ENSURE THAT ALL INSTRUCTIONS ARE UNDERSTOOD PRIOR TO FITMENT
 PLACE THESE INSTRUCTIONS IN THE VEHICLES'S GLOVEBOX AFTER INSTALLATION IS COMPLETED

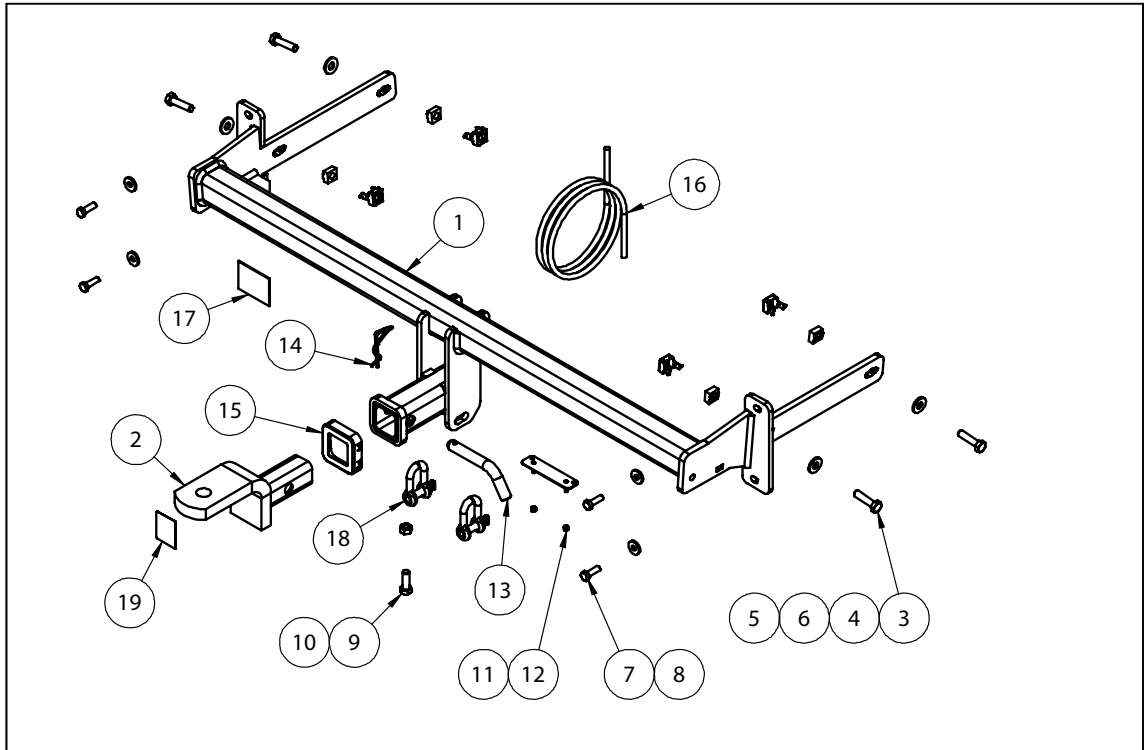

QTY	DESCRIPTION	ITEM NO
1	WELDED ASSEMBLY	1
1	TBM ASSEMBLY	2
4	BOLT M10-1.5X40MM	3
4	WASHER FT M10X25.4X3	4
4	CAGE NUT RETAINER	5
4	CAGE NUT M10X1.5	6
4	SETSCREW M8X25	7
4	FLAT WASHER M8X22X3.3MM	8
1	SET SCREW HEX HD M10X30X1.5P	9
1	HEX NUT M10X1.5	10
1	PLUG BRACKET	11
2	NUT NYLOC MA-07 Z/P	12
1	PULL PIN	13
1	SPRING COTTER PIN ASSY	14
1	COLLAR COVER RL HR LOGO	15
1	WIRING LOOM	16
1	COMPLIANCE PLATE	17
2	D SHACKLE	18
1	H. R STICKER	19

HAYMAN REESE

PART No: 03105RLW

SKODA OCTAVIA NE WAGON 11-13 ON

INSTALLATION INSTRUCTIONS

PLEASE ENSURE THAT ALL INSTRUCTIONS ARE UNDERSTOOD PRIOR TO FITMENT
PLACE THESE INSTRUCTIONS IN THE VEHICLES'S GLOVEBOX AFTER INSTALLATION IS COMPLETED

1. Remove 4xScrews in rear wheel arch. Repeat for opposite side of vehicle.

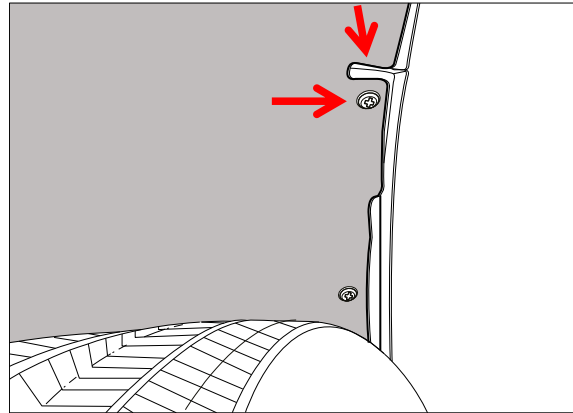
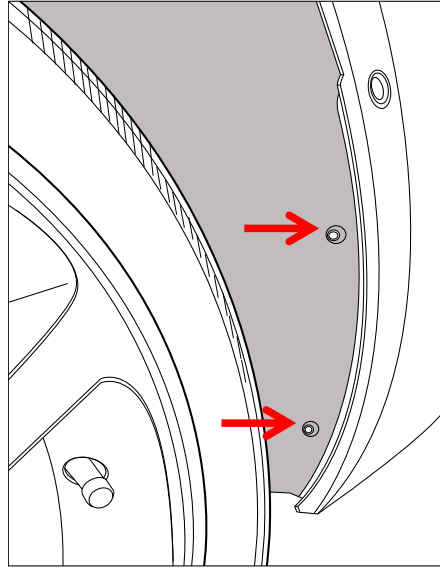

2. Remove 2xScrews from Bumper trim under right side of vehicle.

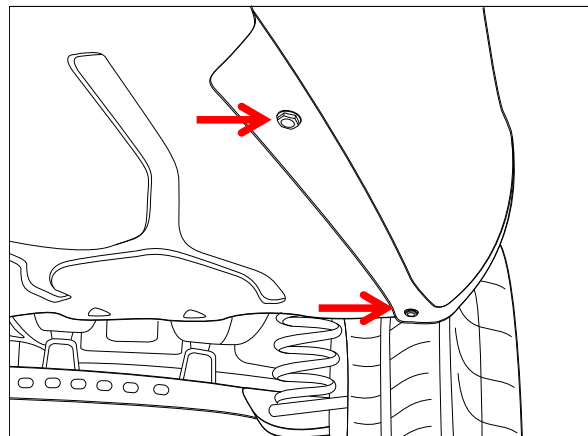

INSTALLATION INSTRUCTIONS

PLEASE ENSURE THAT ALL INSTRUCTIONS ARE UNDERSTOOD PRIOR TO FITMENT
PLACE THESE INSTRUCTIONS IN THE VEHICLES'S GLOVEBOX AFTER INSTALLATION IS COMPLETED

3. Remove 4xScrews from Bumper trim under rear of vehicle.

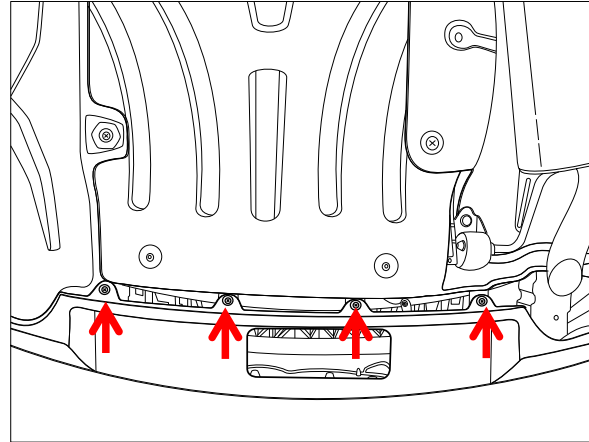

4. Remove cover over Screw in the tail light assembly in boot cavity. Remove newly exposed screw.
5. Remove trim in boot cavity adjacent to tail light assembly. Remove 2xexposed Screws securing tail light assembly.
6. Repeat steps 4 and 5 for opposite side of vehicle.

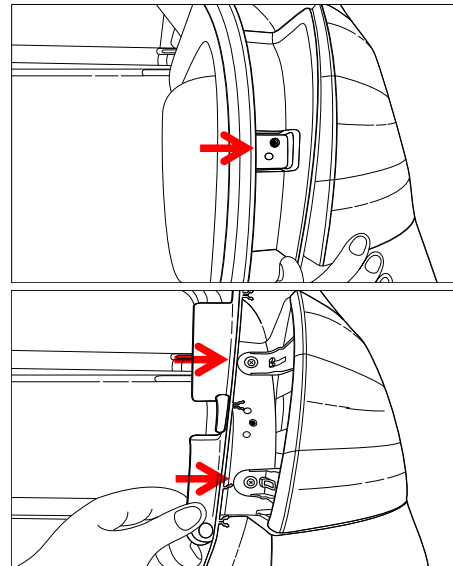

7. Unplug tail lights and remove tail light assembly. Repeat for opposite side of vehicle.

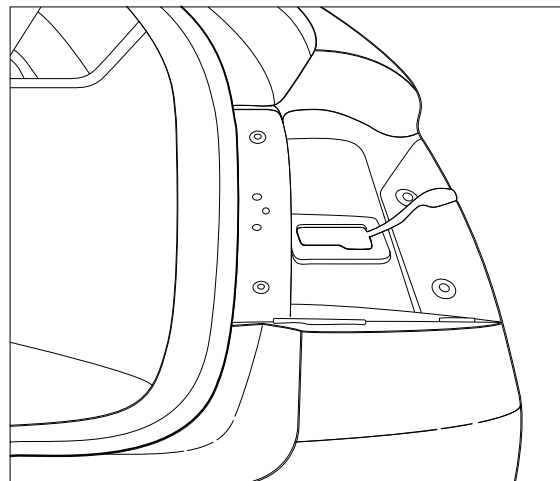

HAYMAN REESE

PART No: 03105RLW

SKODA OCTAVIA NE WAGON 11-13 ON

INSTALLATION INSTRUCTIONS

PLEASE ENSURE THAT ALL INSTRUCTIONS ARE UNDERSTOOD PRIOR TO FITMENT
PLACE THESE INSTRUCTIONS IN THE VEHICLES'S GLOVEBOX AFTER INSTALLATION IS COMPLETED

8. Unclip and remove Bumper skin, disconnecting the parking sensors as Bumper is removed.

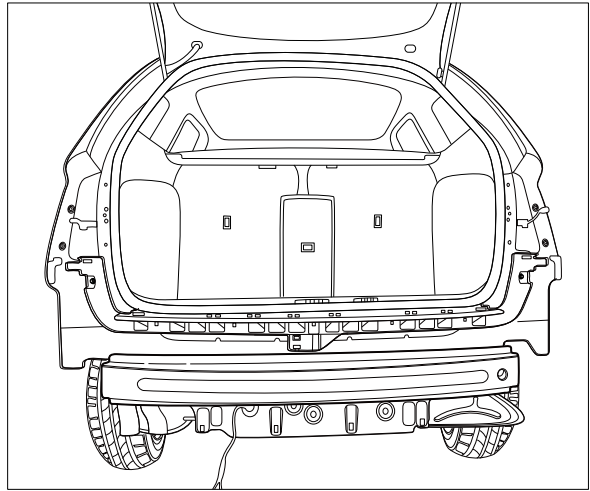

9. Remove and discard 3xScrews from impact beam on LHS of vehicle and 4xScrews from impact beam on RHS of vehicle. Remove and discard Impact beam.

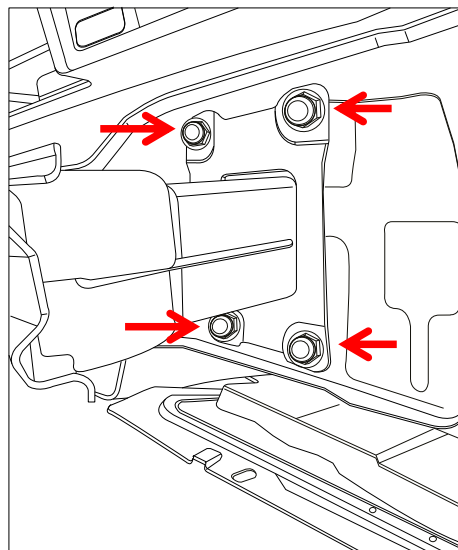
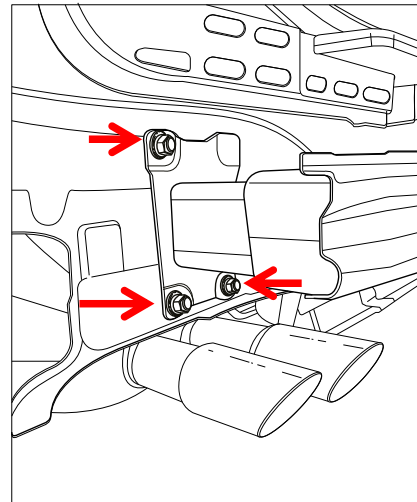

HAYMAN REESE

PART No: 03105RLW

SKODA OCTAVIA NE WAGON 11-13 ON

INSTALLATION INSTRUCTIONS

PLEASE ENSURE THAT ALL INSTRUCTIONS ARE UNDERSTOOD PRIOR TO FITMENT
PLACE THESE INSTRUCTIONS IN THE VEHICLES'S GLOVEBOX AFTER INSTALLATION IS COMPLETED

10. Install Cage Nuts onto side arms in the 4 profiled holes.

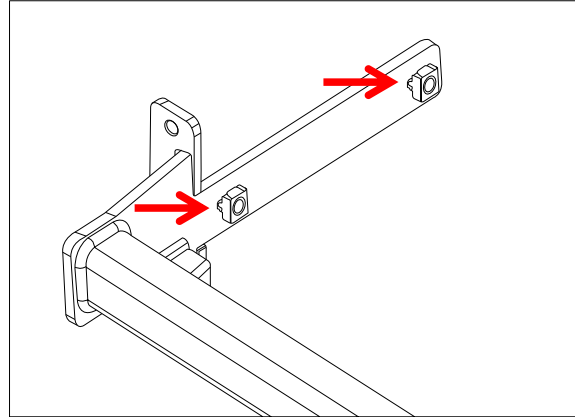

11. Place Towbar inside chassis rails. Loosely secure Towbar to side of chassis rail with two M10 x 40 Bolts. Loosely secure Towbar to rear panel with two M8 x 25 Set Screws. Repeat for opposite side of vehicle. Tighten all fasteners to torque specified on page 2.

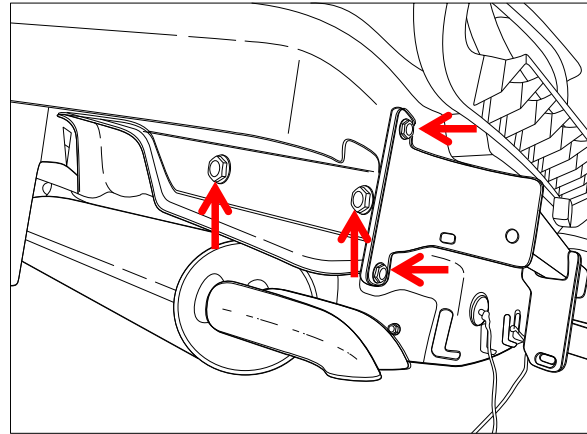

12. Determine centre of Bumper. Make 80mm wide cut in Bumper starting from lower edge of bumper through to the bumper window. Make an 80mm wide cut in bumper starting from edge of bumper window 50mm high.
13. Refit Bumper skin by following steps 1-8 in reverse order.

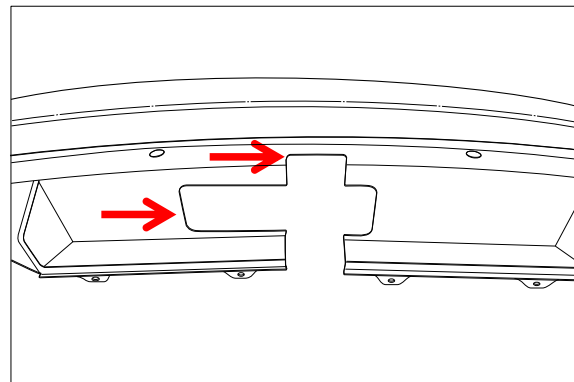

HAYMAN REESE
PART No: 101271-WL
SKODA OCTAVIA WAGON

INSTALLATION INSTRUCTIONS

PLEASE ENSURE THAT INSTRUCTIONS ARE UNDERSTOOD PRIOR TO FITMENT

Wiring Loom Installation Instructions

SKODA OCTAVIA WAGON
Part No: 101271-WL
ECU Required Part No: 04828

Tail Harness Length Required: 1200mm

Wiring Loom Installation Time: Approx 30 Mins

Important



Due to possible vehicle variations, always confirm any noted vehicle colour wires with a multi-meter to ensure the correct function is identified before soldering or scotch locking.

Issue Date 17-12-14

Page 1

Hayman Reese (Cequent)
PO Box 4050, Dandenong South VIC 3164
Phone 1800 812 017 Email info@haymanreese.com.au

www.haymanreese.com.au



HAYMAN REESE
PART No: 101271-WL
SKODA OCTAVIA WAGON

INSTALLATION INSTRUCTIONS

PLEASE ENSURE THAT INSTRUCTIONS ARE UNDERSTOOD PRIOR TO FITMENT

1. In the luggage compartment, remove the floor cover carpet (1), parcel shelf (2) and fold the rear seats (3) forward. Remove the rear trim (4).

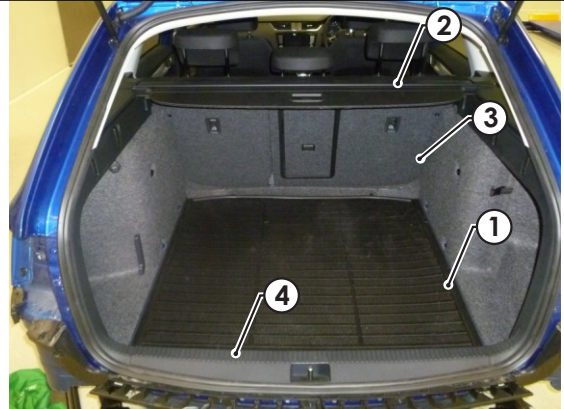

2. Remove the driver's side rear passenger arm rest trim (1).
 3. Remove the RHS luggage compartment plastic trim fasteners (2) and then remove the trim (3).
 4. Remove the RHS luggage compartment trim fasteners (4) and then dislodge the trim (5).
- Repeat for the LHS.**

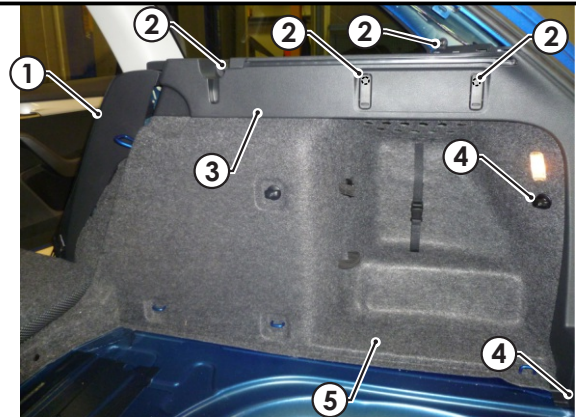

5. Dislodge the 'B' pillar lower trim and remove the LHS rear passenger kick trim (1).



Issue Date 17-12-14

Page 2

Hayman Reese (Cequent)
PO Box 4050, Dandenong South VIC 3164
Phone 1800 812 017 Email info@haymanreese.com.au

HAYMAN REESE
PART No: 101271-WL
SKODA OCTAVIA WAGON

INSTALLATION INSTRUCTIONS

PLEASE ENSURE THAT INSTRUCTIONS ARE UNDERSTOOD PRIOR TO FITMENT

6. Dislodge the 'B' pillar lower trim (1) and remove the front passenger side scuff trim (2).
7. Remove passenger dash side trim (3) and the glove box (4).

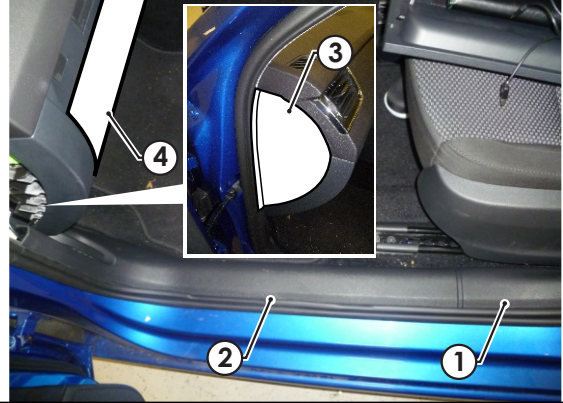

8. At the RHS rear quarter, near the vent, locate and remove the vehicle grommet (1). If the grommet hole is occupied, choose a suitable location (2) next to the existing grommet (1) and drill a Ø30mm hole. Apply rust inhibitor after drilling (not supplied).

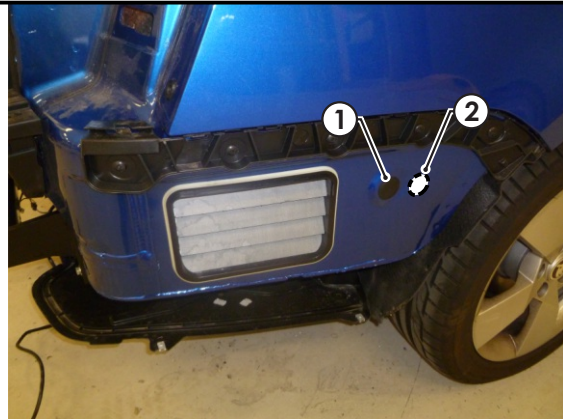

9. Locate the vehicle RHS tail light harness. Following the table below, connect the ezy-taps (1) to the corresponding vehicle wires (2), then connect the trailer patch (P/No: 101271-WL) terminals (3) to the ezy-taps (1). Due to possible vehicle variations, ensure to use a multi-meter to determine the correct signals.

Function	Trailer Patch	Vehicle Wire
R.IND	GREEN / BLACK	GREEN / BLACK
REVERSE	BLACK / WHITE	BLACK / BLUE
TAIL BRAKES	RED / BLACK	WHITE / BLACK

10. Route the trailer patch LHS branch along the rear of the vehicle and across to the LHS tail light connectors.

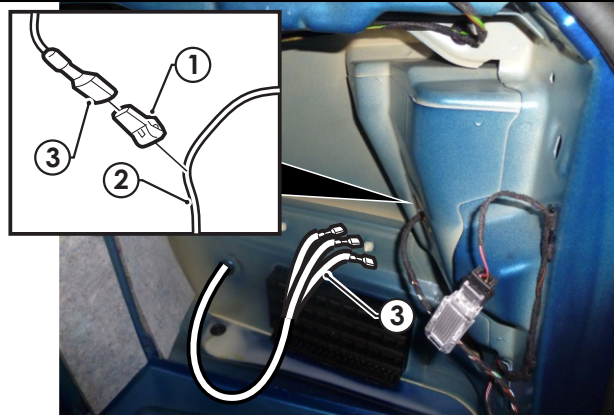

Issue Date 17-12-14

Page 3

Hayman Reese (Cequent)
 PO Box 4050, Dandenong South VIC 3164
 Phone 1800 812 017 Email info@haymanreese.com.au



HAYMAN REESE

PART No: 101271-WL

SKODA OCTAVIA WAGON

INSTALLATION INSTRUCTIONS

PLEASE ENSURE THAT INSTRUCTIONS ARE UNDERSTOOD PRIOR TO FITMENT

11. Connect the trailer patch connector (1) to the ECU (2). Remove the backing from the back of the ECU and mount the ECU (2) onto a suitable location on the RHS rear quarter sheet metal area (3) where it will not be an obstruction. **Ensure ECU is mounted with the connector end pointing downwards.**

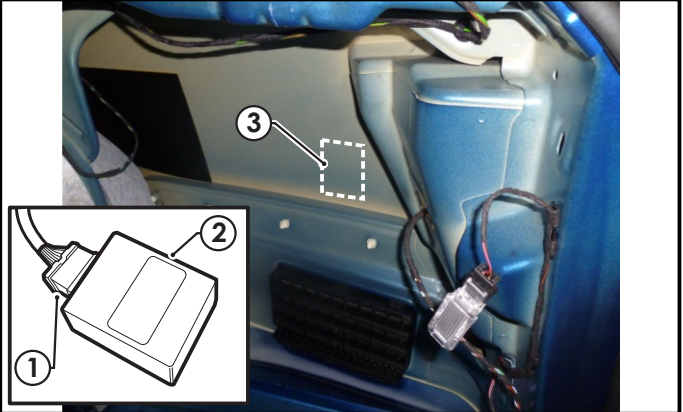

12. Locate the vehicle LHS tail light harness. Following the table below, connect the ezy-tap (1) to the corresponding vehicle wire (2), then connect the trailer patch terminal (3) to the ezy-tap (1). Due to vehicle variations, ensure to use a multi-meter to determine the correct signals.

Function	Trailer Patch	Vehicle Wire
L.IND	YELLOW / BLACK	GREY / PURPLE

13. Secure the trailer patch ground ring terminal (4) to the vehicle sheet metal at a suitable location using a tek screw (not supplied).

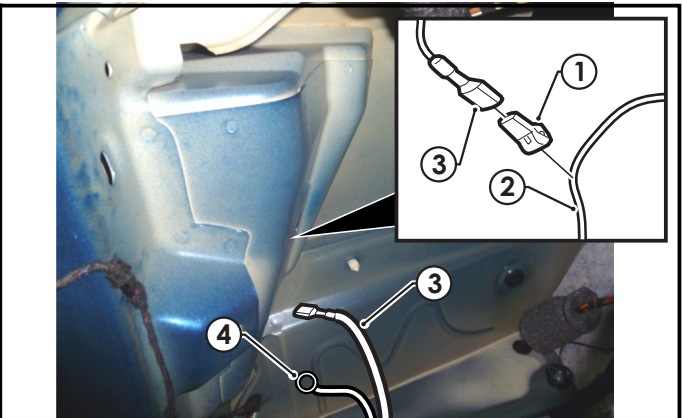

14. Remove the indicated vehicle 10A fuse (1). Insert the vehicle fuse 10A fuse (1) and the supplied 20A fuse (2) to the add-a-fuse harness (3). Connect the trailer patch 1-way connector (4) to the add-a-fuse harness (3). Insert the add-a-fuse harness (5) to the previously removed fuse location (6).

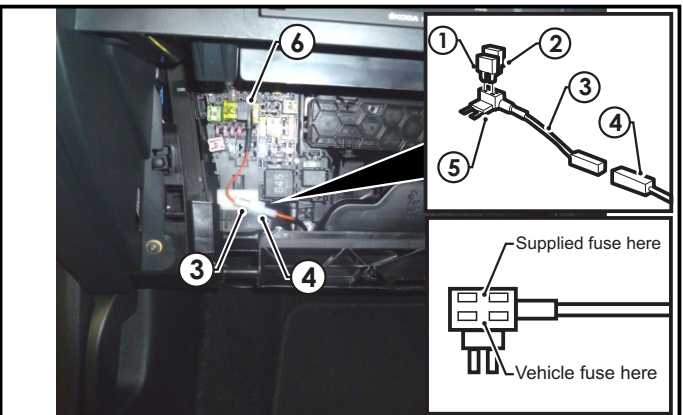

Issue Date 17-12-14

Page 4

Hayman Reese (Cequent)
 PO Box 4050, Dandenong South VIC 3164
 Phone 1800 812 017 Email info@haymanreese.com.au

HAYMAN REESE
PART No: 101271-WL
SKODA OCTAVIA WAGON

INSTALLATION INSTRUCTIONS

PLEASE ENSURE THAT INSTRUCTIONS ARE UNDERSTOOD PRIOR TO FITMENT

15. At the rear exterior of the vehicle, mount the tail harness socket (1) to the towbar mounting bracket using M4 fasteners (not supplied).
16. Route the tail harness (tail length: 1200mm) (2) across the RHS and up into the drilled out (or existing) grommet hole (3). Adjust the trailer patch harness grommet (4) so that it is seated correctly and cable tie (not supplied) in place.

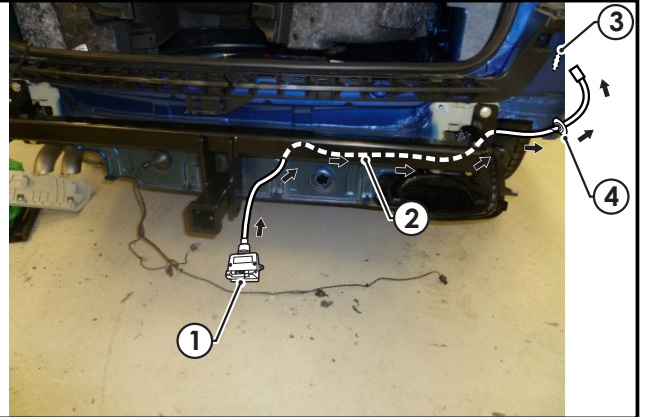

17. Connect the tail harness 8-way connector (1) to the trailer patch 8-way mating connector (2).

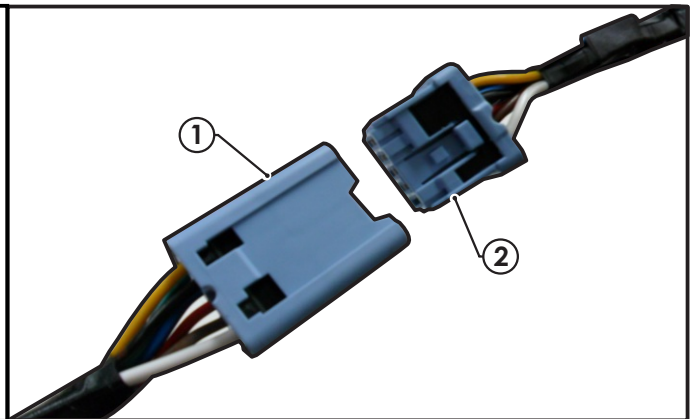

18. Test the body harness using a light board or multimeter.
19. Secure all harnesses using cable ties (not supplied).
20. Re-fit all removed parts and secure all fasteners, ensuring there are no squeaks or rattles.
21. Place the instructions in the glove box after fitment.

Issue Date 17-12-14

Page 5

Hayman Reese (Cequent)
PO Box 4050, Dandenong South VIC 3164
Phone 1800 812 017 Email info@haymanreese.com.au

www.haymanreese.com.au

