

HAYMAN REESE
PART No: **03075RLW**
BMW 125i (F20)

INSTALLATION INSTRUCTIONS

PLEASE ENSURE THAT ALL INSTRUCTIONS ARE UNDERSTOOD PRIOR TO FITMENT
PLACE THESE INSTRUCTIONS IN THE VEHICLE'S GLOVEBOX AFTER INSTALLATION IS COMPLETED



Installation Time: Approx **75** Mins

Towbar Installation Instructions

Towbar capacity

BMW 125i (F20)

Part Number **03075RLW**

| | |
|----------------------|---------|
| Max Towing Braked | 1200 kg |
| Max Towing Unbraked | 750 kg |
| Max Static Ball Load | 120 kg |

Hayman Reese (Cequent)
PO Box 4050, Dandenong South VIC 3164
Phone 1800 812 017 Email info@haymanreese.com.au

INSTALLATION INSTRUCTIONS

PLEASE ENSURE THAT ALL INSTRUCTIONS ARE UNDERSTOOD PRIOR TO FITMENT
PLACE THESE INSTRUCTIONS IN THE VEHICLES'S GLOVEBOX AFTER INSTALLATION IS COMPLETED

Warning:

1. Do not, drill, cut, weld or otherwise modify the towbar.
2. If you are using electric welding on a motor vehicle, **always** check that the vehicle is not equipped with electronic engine or instrument management equipment. Failure to do so could **destroy** any onboard computers. If in doubt, check with the vehicle's manufacturer.
3. If TBM is used in inverted position tow ball may make contact with rear tailgate when lowered, which could cause damage.

General:

1. Ensure all hardware items have been included refer to assembly diagram.
2. It is recommended that the instructions are read through and completely understood before making any attempt to fit this product.
3. Be wary of any changes to vehicle designs or other accessories that may conflict with the installation of this product.
4. Before drilling ensure that the area is clear of fuel, electrical & other components.
5. All holes drilled into the body panels shall have all burrs & swarf removed then coated with a suitable rust preventative paint.
6. The high tensile fasteners supplied with this product were used to achieve the specified rating. If replacement is required ensure that fasteners of the same rating & quality are used. Contact an authorised **Hayman Reese** dealer if further information is required.
7. Ensure that all hardware is fastened to torque list below check fasteners on regular basis.
8. Towbar load rating sticker provided with this product shall be conspicuously located on inside rear end of the driver's door. **(See diagram below).**
9. Hayman Reese recommends that you check your tow ball to ensure that it complies with the Australian standards **AS 4177.2**.
10. **PLEASE NOTE:** It is advised to remove your lug or tbn when not actually towing so as to produce a clear view of the vehicles registration plate if obscured, and to also provide maximum available departure angle.
11. Pull Pin must be fit in down position.

Tow bar Maintenance and Care.

Hayman Reese recommends that bolt torque's, as listed below, are routinely and regularly inspected and checked for correct tension. Replace any worn or defective parts.

We recommended to remove Tow Ball Mounts (TBM's, tongues or lugs) when not being used for any considerable length of time.

So as to avoid injury, when not towing it is suggested that the tongue, Pull Pin and R-clip are removed then stored in a safe, clean and dry place, away from excessive moisture.

Hitch Pull Pins and spring "R" clips are regularly checked for proper installation. Replace any worn or defective parts.

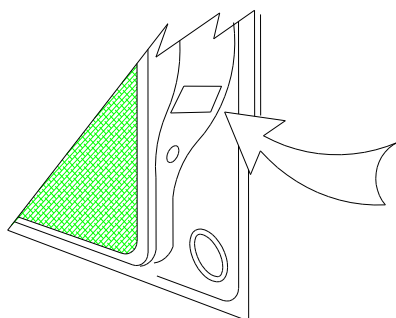

Place load rating sticker
inside driver's door here

RECOMMENDED ASSEMBLY TORQUE LISTING

Diameter Grade 8.8 Bolt

| | |
|-----|----------|
| M6 | 9.5 Nm |
| M8 | 21.7 Nm |
| M10 | 43.4 Nm |
| M12 | 77.3 Nm |
| M14 | 146 Nm |
| M16 | 189.8 Nm |

FOR TOWING PURPOSES ONLY

For towing capacity details please refer to vehicle owner's manual or to the manufacturer. Overloading can void your warranties.

HAYMAN REESE
PART No: 03075RLW
BMW 125i (F20)

INSTALLATION INSTRUCTIONS

PLEASE ENSURE THAT ALL INSTRUCTIONS ARE UNDERSTOOD PRIOR TO FITMENT
 PLACE THESE INSTRUCTIONS IN THE VEHICLES'S GLOVEBOX AFTER INSTALLATION IS COMPLETED

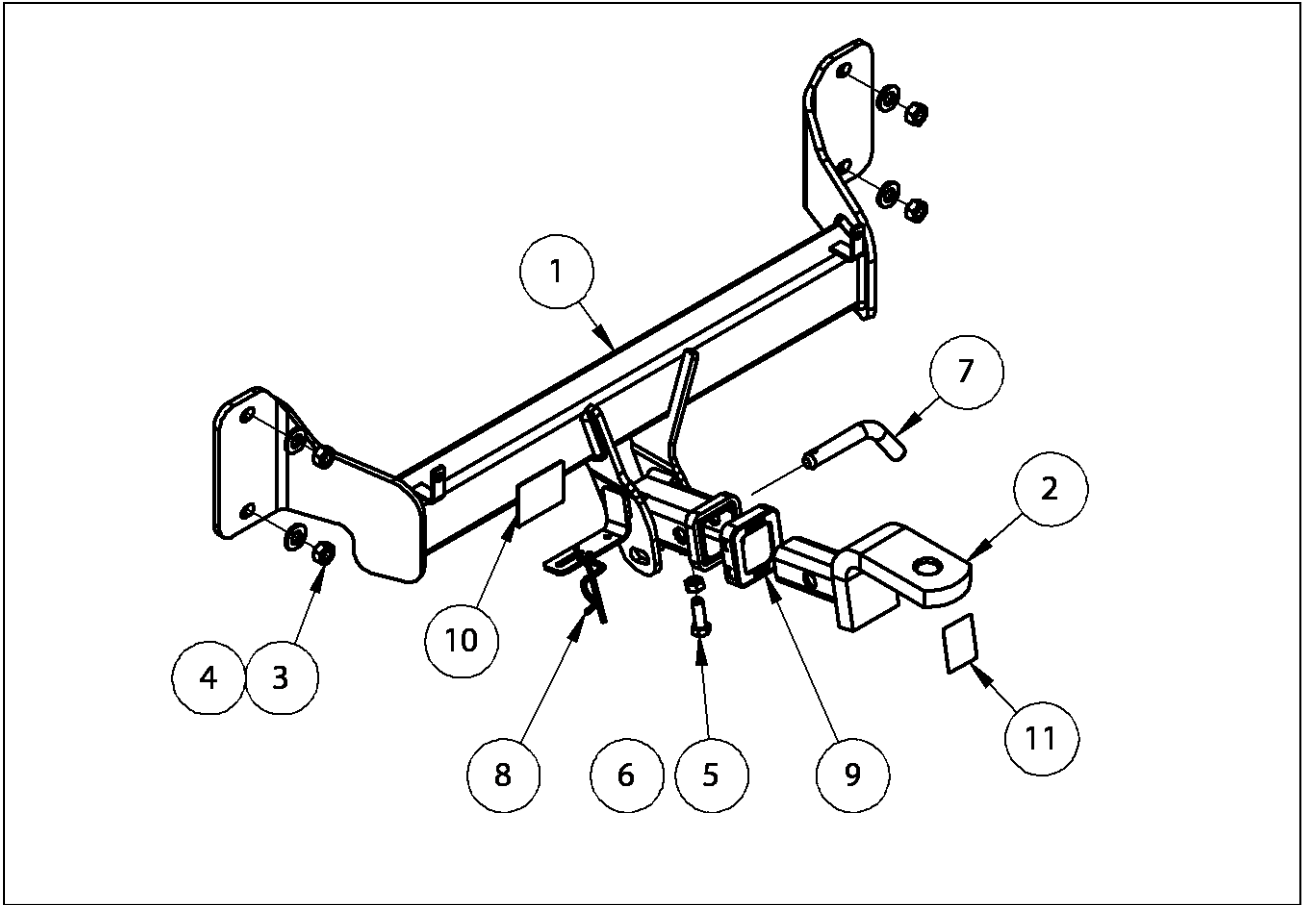

| QTY. | DESCRIPTION | ITEM NO. |
|------|-------------------------------|----------|
| 1 | WELDED ASSEMBLY | 1 |
| 1 | T.B MOUNT 21133 | 2 |
| 4 | M12x1.5 HEX NUT PC8 | 3 |
| 4 | WASHER FLAT 1/2" x1 1/8"x1/8" | 4 |
| 1 | SET SCREW HEX HD M10x30x1.5P | 5 |
| 1 | HEX NUT M10x1.5 | 6 |
| 1 | PULL PIN | 7 |
| 1 | SPRING COTTER PIN ASSY | 8 |
| 1 | HR H/BOX COLLAR COVER | 9 |
| 1 | ADR COMPLIANCE LABEL | 10 |
| 1 | H.R STICKER | 11 |

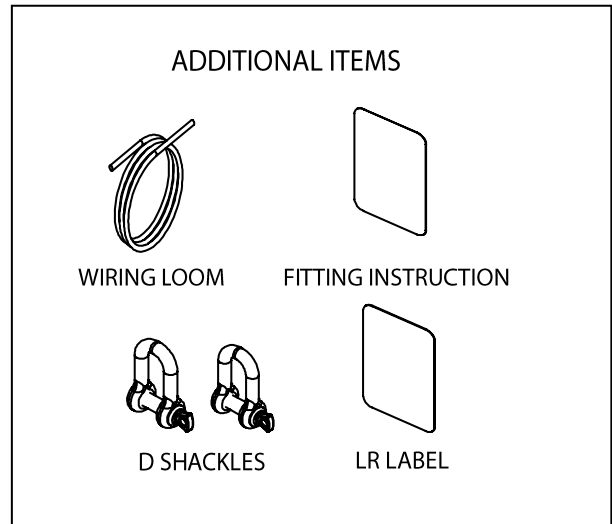

INSTALLATION INSTRUCTIONS

PLEASE ENSURE THAT ALL INSTRUCTIONS ARE UNDERSTOOD PRIOR TO FITMENT
PLACE THESE INSTRUCTIONS IN THE VEHICLE'S GLOVEBOX AFTER INSTALLATION IS COMPLETED

1. Remove 3 screws inside the LHS wheel arch.

Pull back internal trim and remove additional screw on Bumper.

Repeat for RHS.

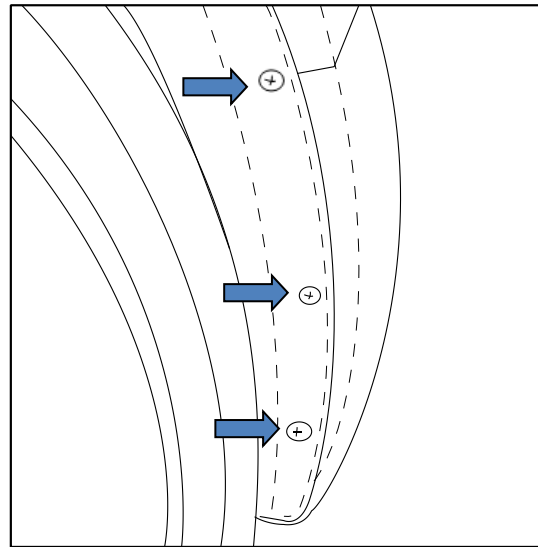

2. Remove 4 x screws from the underside of the Bumper on the LHS.

Repeat for RHS.

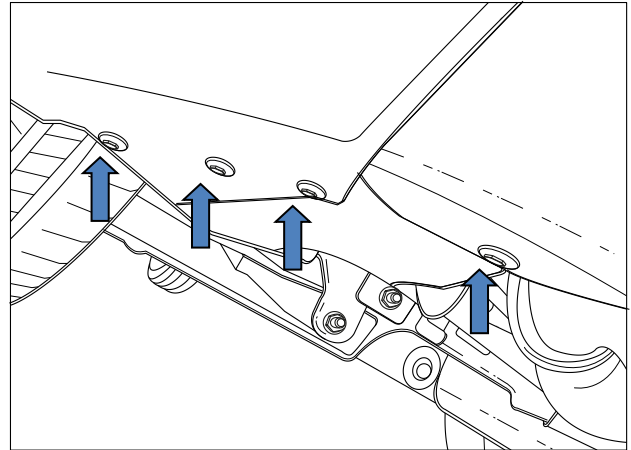

3. Remove the LHS rear taillight cover, and remove 1 x nut securing the taillight to the vehicle.

Remove the taillight assembly; ensure the wiring is disconnected during the removal.

Repeat for RHS.

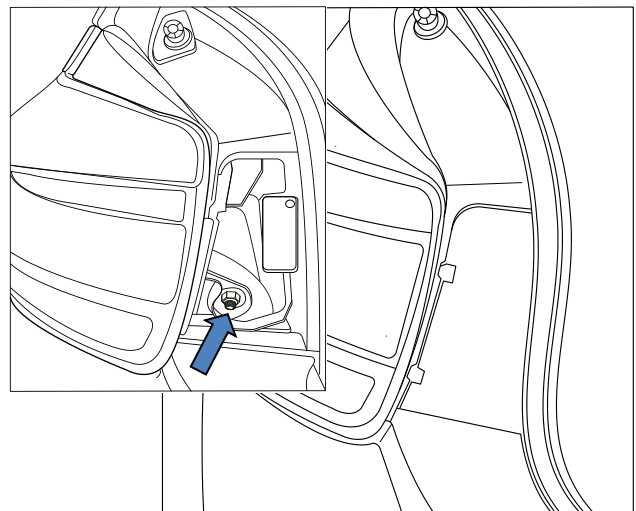

INSTALLATION INSTRUCTIONS

PLEASE ENSURE THAT ALL INSTRUCTIONS ARE UNDERSTOOD PRIOR TO FITMENT
PLACE THESE INSTRUCTIONS IN THE VEHICLE'S GLOVEBOX AFTER INSTALLATION IS COMPLETED

4. Remove the Bumper via unclipping the sides and pulling firmly.

When removing the bumper, ensure any wiring is disconnected.

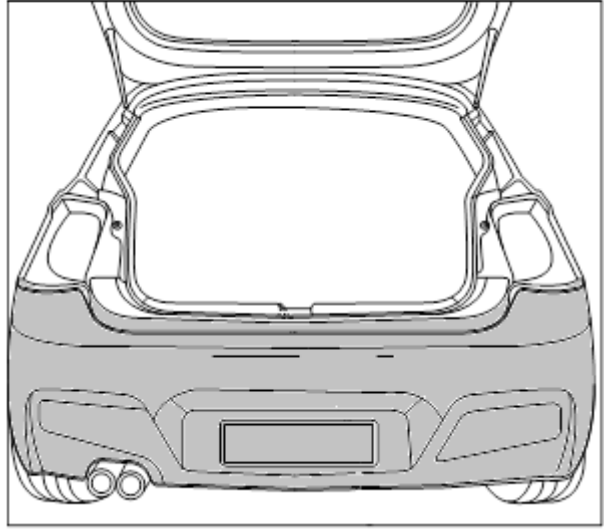

5. Remove 1 x screw on each side of the impact beam attaching the heat shield.

Remove 2 x nuts on each side of the impact beam.

Discard the Impact Beam but retain the nuts and screws for later use.

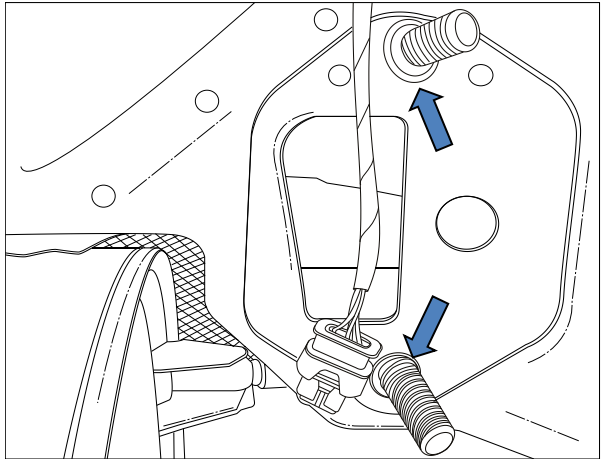

6. Offer the main towbar assembly to the vehicle.

Loosely secure each side with the 2 x M12 nuts removed in Step 5.

Tighten all bolts to the recommended torque settings.

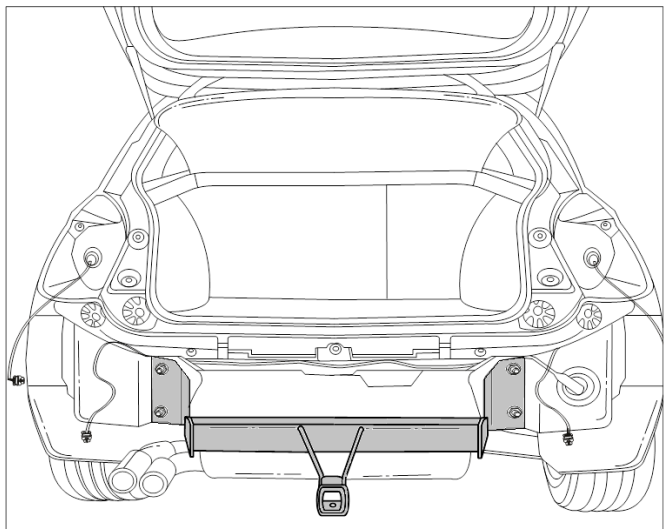

INSTALLATION INSTRUCTIONS

PLEASE ENSURE THAT ALL INSTRUCTIONS ARE UNDERSTOOD PRIOR TO FITMENT
PLACE THESE INSTRUCTIONS IN THE VEHICLE'S GLOVEBOX AFTER INSTALLATION IS COMPLETED

7. Secure the heat shield to the towbar tabs using the 2 x screws removed in Step 5.

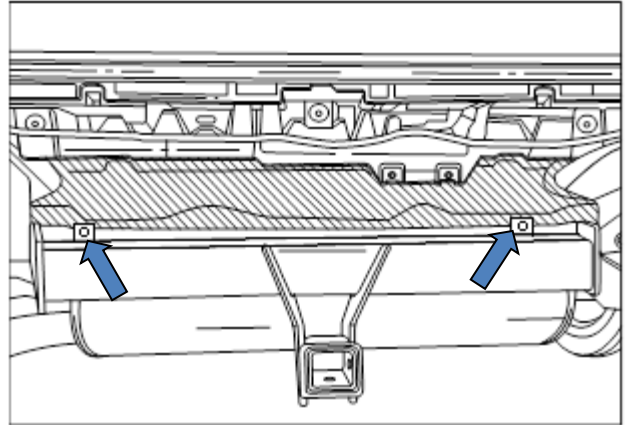

8. Perform the bumper cut out as shown in the following image by measuring 40mm each side from the centre of the bumper, and 75mm upwards.

Re-fit bumper and all other components in reverse order.

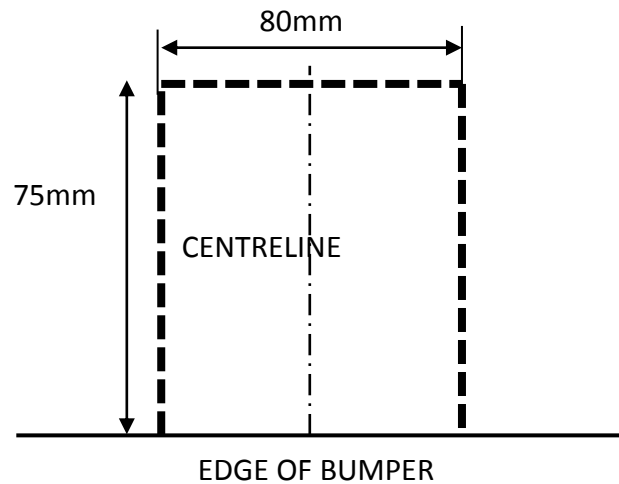

HAYMAN REESE
PART No: 101197-WL
BMW 125 F20

INSTALLATION INSTRUCTIONS

PLEASE ENSURE THAT INSTRUCTIONS ARE UNDERSTOOD PRIOR TO FITMENT

Wiring Loom Installation Instructions

BMW 125 F20

Part No: 101197-WL
ECU Required: 04840

Tail Harness Length Required: 1800mm

Wiring Loom Installation Time: Approx. 20 minutes

Issue Date 30-07-14

Page 1

Part No: 101197-WL

Hayman Reese (Cequent)
PO Box 4050, Dandenong South VIC 3164
Phone 1800 812 017 Email info@haymanreese.com.au

www.haymanreese.com.au



HAYMAN REESE
PART No: 101197-WL
BMW 125 F20

INSTALLATION INSTRUCTIONS

PLEASE ENSURE THAT INSTRUCTIONS ARE UNDERSTOOD PRIOR TO FITMENT

1. At the rear of the vehicle, access the luggage compartment and fold down the rear seats (1).
2. Remove the floor carpet (2).
3. Remove the luggage compartment rear trim fasteners (3) and then remove the trim (4).

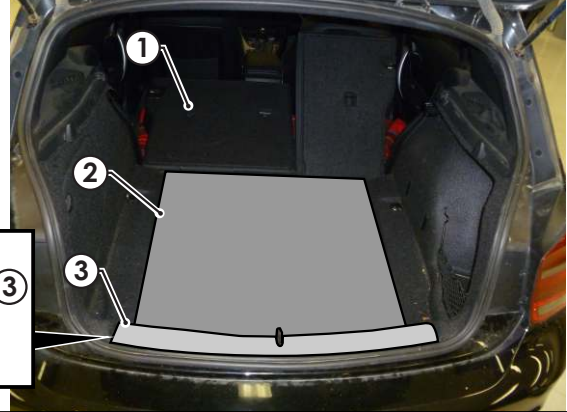
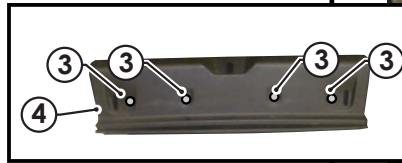

4. Remove the appropriate fastener (1) and light connector and remove the RHS luggage compartment trim (2) to access the RHS rear quarter area.



5. At the RHS rear quarter, locate and remove the vehicle grommet closest to the rear (1) and drill a Ø30mm hole into the grommet hole (1). If the grommet location (1) is occupied, drill into the sheet metal in a location nearby.
6. Apply rust inhibitor after drilling.



Issue Date 30-07-14

Page 2

Part No: 101197-WL

Hayman Reese (Cequent)
PO Box 4050, Dandenong South VIC 3164
Phone 1800 812 017 Email info@haymanreese.com.au

www.haymanreese.com.au



HAYMAN REESE

PART No: 101197-WL
BMW 125 F20

INSTALLATION INSTRUCTIONS

PLEASE ENSURE THAT INSTRUCTIONS ARE UNDERSTOOD PRIOR TO FITMENT

7. Following the table below, connect the trailer patch (P/No: 101197-WL) ezy-taps (1) to the corresponding vehicle wires (2), then connect the trailer patch terminal (3) to the ezy-taps (1).

| Function | Trailer Patch | Vehicle Harness |
|----------|----------------|-----------------|
| TAIL | BROWN / BLACK | GREY / PURPLE |
| REVERSE | BLACK / WHITE | GREY / BLUE |
| R.IND | GREEN / BLACK | BLACK / GREY |
| BRAKE | RED / BLACK | BLACK / YELLOW |
| L.IND | YELLOW / BLACK | BLACK / WHITE |

8. Secure the trailer patch ground ring (4) to the vehicle grounding point (5).

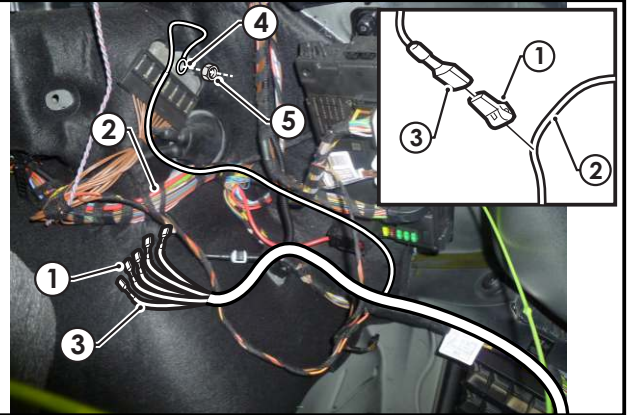

9. Connect the trailer patch ECU connector (1) to the ECU (P/No: 04840) (2).
10. Remove the adhesive backing from the ECU (2) and secure the ECU (2) onto the vehicle sheet metal area located in the RHS rear quarter cavity above the wheel arch (3). **Ensure the ECU is secured with the connector pointing downwards.**

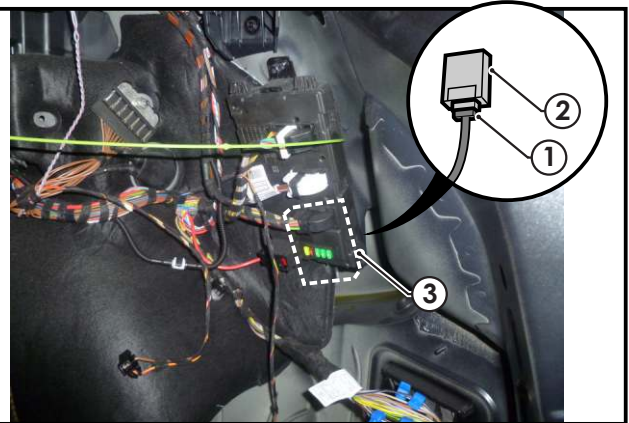

11. Remove the indicated vehicle 15A fuse (1). Insert the vehicle fuse 15A fuse (1) and the supplied 20A fuse (2) to the add-a-fuse harness (3). Connect the trailer patch 1-way connector (4) to the add-a-fuse harness (3). Insert the add-a-fuse harness (5) to the previously removed fuse location (6).

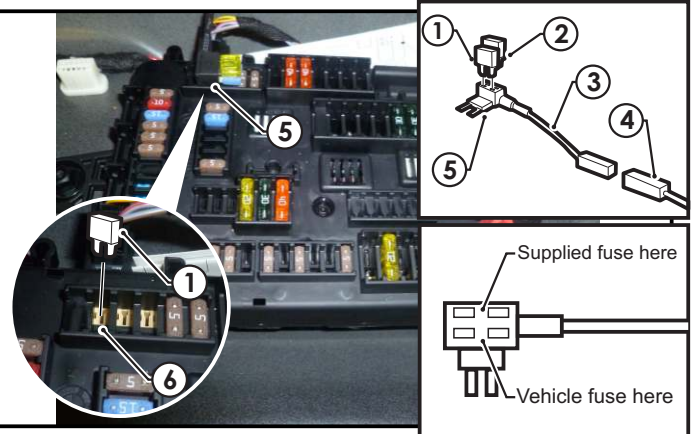

Issue Date 30-07-14

Page 3

Part No: 101197-WL

Hayman Reese (Cequent)
PO Box 4050, Dandenong South VIC 3164
Phone 1800 812 017 Email info@haymanreese.com.au

www.haymanreese.com.au



HAYMAN REESE
PART No: 101197-WL
BMW 125 F20

INSTALLATION INSTRUCTIONS

PLEASE ENSURE THAT INSTRUCTIONS ARE UNDERSTOOD PRIOR TO FITMENT

12. At the rear exterior of the vehicle, mount the tail harness socket (1) to the towbar mounting bracket using M4 fasteners (not supplied).
13. Route the tail harness (tail length: 1800mm) (2) across the RHS and up into the drilled out hole (3). Adjust the trailer patch harness grommet so that it is seated correctly and cable tie (not supplied) in place.



14. Connect the tail harness 8-way connector (1) to the trailer patch 8-way mating connector (2).

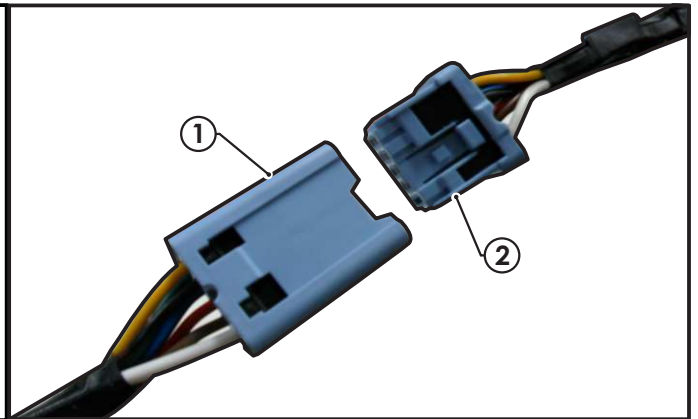

15. Test the trailer wiring harness function using a light board or multimeter.
16. Secure all harnesses using cable ties (not supplied).
17. Re-fit all removed parts and secure all fasteners, ensuring there are no squeaks or rattles.
18. Place the fitting instructions in the glove box after fitment.

Issue Date 30-07-14

Page 4

Part No: 101197-WL

Hayman Reese (Cequent)
PO Box 4050, Dandenong South VIC 3164
Phone 1800 812 017 Email info@haymanreese.com.au

www.haymanreese.com.au

